

MODEL		EV 12 800 95 DN18	EV 13S 1000 101 DN18	EV 12S 1500 120 DN18	EV 15S 2000 130 DN18
Art. number	Nº	305426	305429	305427	305435
Capacity	L	768	932	1439	1853
Net weight	kg	221	233	371	442
Insulation	mm	100	100	100	100
<b>Heat exchanger surface S1</b>	<b>m²</b>	<b>2.89</b>	<b>3.45</b>	<b>3.3</b>	<b>4.5</b>
Heat exchanger capacity S1	L	26.2	31.3	30.4	41.6
Heat losses ΔT 45K	W	129	142	158	183
Energy efficiency class	C	C	C	C	C
Maximum operational temperature	°C	95	95	95	95
Maximum operational temperature of heat exchanger	°C	110	110	110	110
<b>Rated pressure</b>	<b>bar</b>	<b>8</b>	<b>8</b>	<b>8</b>	<b>8</b>
Rated pressure of the heat exchanger	bar	6	6	6	6
Heat exchanger reheat performance P at flow rate of primary side (S1)	kW / (L/min)	6.1 / (100)	7.2 / (100)	94.5 / (100)	113.1 / (100)
V40 - hot water delivered with a temperature of at least 40°C (S1)	L	1095.2	1403	1933.8	2785
Reheat time 10-60°C flow rate at primary side (S1)	min / (L/min)	48.85 / (50)	50.15 / (50)	45.3 / (100)	57.26 / (100)
Coil Pressure drop at flow rate m³/h (S1)	mbar / (L/min)	69.0 / (50)	82.6 / (50)	222.14 / (100)	294.8 / (100)

\* outlet - inlet temperature of the heat transfer fluid

\*\* 10°C - cold water temperature, 60°C - hot water temperature (domestic water)

All models from 750 L to 2000 L are fitted with the new INSU PRO insulation.

#### INSTALLATION AND CONNECTION SCHEME

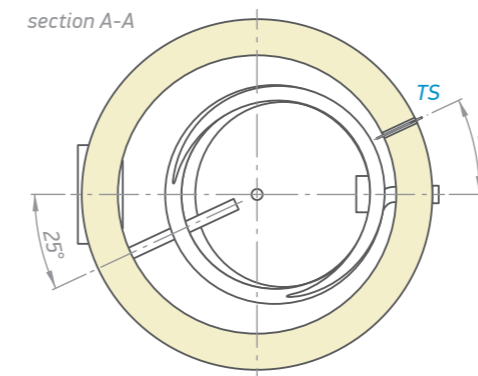
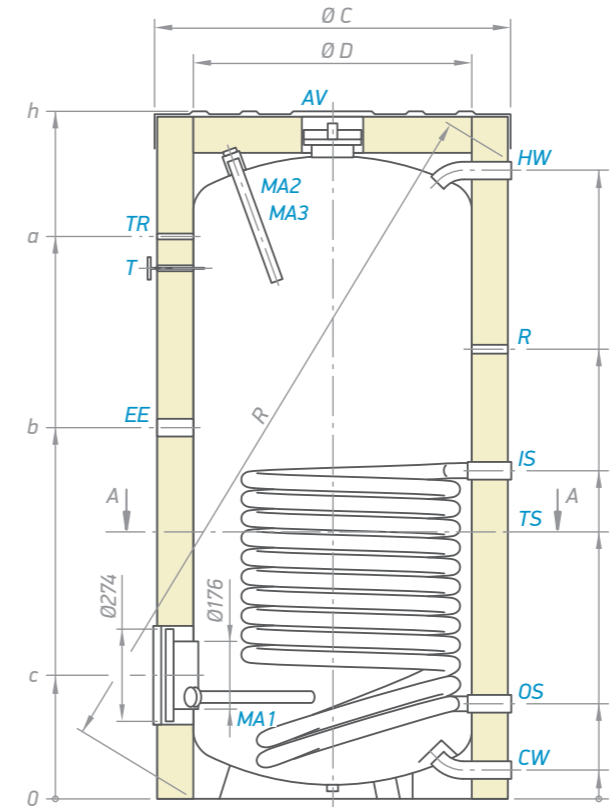
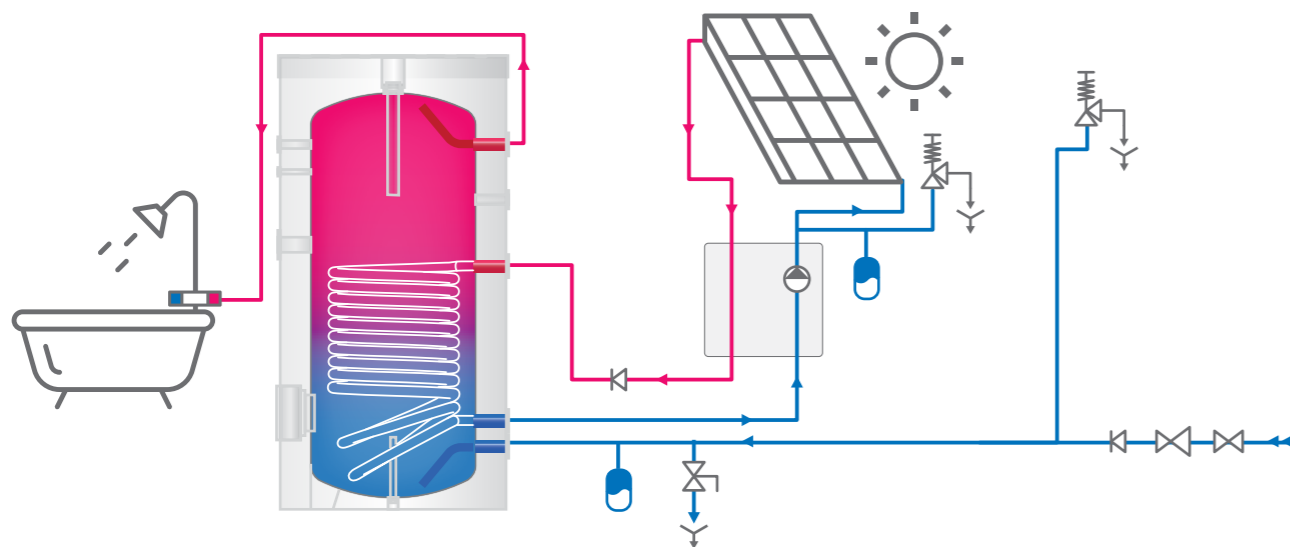

MODEL		EV 12S 800 95 DN18	EV 12S 1500 120 DN18
CW	cold water inlet	G 1½"B	G 2"B
HW	hot water outlet	G 1½"B	G 2"B
IS1	heat exchanger inlet	G 1½"B	G 1½"B
OS1	heat exchanger outlet	G 1½"B	G 1½"B
R	recirculation	G ¾"	G 1½"
T	thermometer	Ø 14 x 1.5	Ø 14 x 1.5
TR	opening for thermoregulator	G ½"	G ½"
TS	thermo sensor pocket level 1	G ½"	G ½"
EE	opening for electric element	G 1½"	G 1½"
MA1	Magnesium anode 1	G 1¼"	G 1¼"
MA2	Magnesium anode 2	G 1¼"	G 1¼"
MA3	Magnesium anode 3	-	G 1¼"

Thread designations according to EN ISO 228-1!

Dimensions ±5 mm		EV 12S 800 95 DN18	EV 13S 1000 101 DN18	EV 12S 1500 120 DN18	EV 15S 2000 130 DN18
h	mm	1947	2012	2193	2399
a	mm	1592	1475	1768	1927
b	mm	1051	1132	1168	1298
c	mm	351	354	468	497
d	mm	1780	1846	2061	2246
f	mm	1273	1274	1378	1551
i	mm	929	987	1081	1235
j	mm	269	272	421	411
k	mm	82.5	81.5	90	90
n	mm	756	830	579	578
R	mm	2012	2097	2361	2592
Ø C	mm	990	1050	1200	1300
Ø D	mm	790	850	1000	1100