



SBL200-12i (12V200Ah)



Applications

- Uninterruptable Power Supply (UPS)
- Electric Power System (EPS)
- Emergency backup power supply
- Emergency light
- Railway signal
- Alarm and security system
- Communication power supply
- DC power supply

Certificates

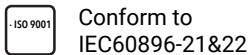

Specifications

Nominal Voltage	12V	Operating Temp. Range	Discharge: -20~50°C
Nominal Capacity	200.0Ah (C ₁₀ , 10.8V)		Charge: -10~50°C
Approx. Weight	59.1kg		Storage: -20~50°C
Terminal	M8	Cycle Use	Initial Charging Current less than 60.0A.
Container Material	ABS UL94 HB		Voltage 14.55V +1% at 20°C.
Rated Capacity (20°C)	210Ah/10.50A, 20hr, 10.8V		Temperature Coefficient -30mV/°C.
	200.0Ah/20.0A, 10hr, 10.8V	Standby Use	No limit on Initial Charging Current.
	194.16Ah/24.27A, 8hr, 10.5V		Voltage 13.65V +1% at 20°C.
	173.5Ah/34.7A, 5hr, 10.5V		Temperature Coefficient -20mV/°C.
	141.3Ah/47.1A, 3hr, 10.5V	Capacity affected by Temp.	40°C 103%
	129.0Ah/129.0A, 1hr, 9.6V		25°C 100%
Max. Discharge Current	1000A (5s)		0°C 86%
Internal Resistance / Impedance (1kHz)	Approx. 4.0mΩ	Self Discharge	SSB batteries may be stored for up to 6 months at 20°C and then a freshening charge is required. For higher temperatures the time interval will be shorter.
Nominal Oper. Temp. R.	20±3°C	Life Expectancy	10-12 years according to EUROBAT

Dimensions

■ M8 Terminal

Unit: mm | Dimensions: 522 Length X 238 Width X 218 Height (223 Height incl. Terminal)

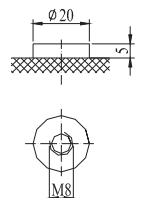
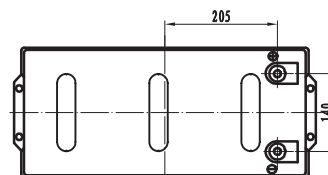
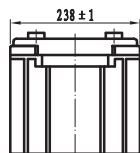
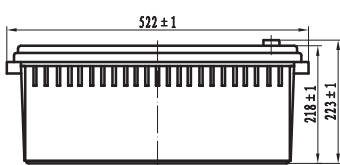

Constant Current Discharge (Amperes) at 20°C

End Point	10min	15min	30min	45min	1h	1.5h	3h	5h	8h	10h	20h
1.60V/cell	-	-	196	-	129	95.3	50.3	36.9	25.5	21.1	10.70
1.65V/cell	-	-	188	-	126	93.1	49.1	36.2	25.08	20.9	10.65
1.70V/cell	-	-	181	-	123	90.8	48.2	35.4	24.7	20.7	10.60
1.75V/cell	-	-	175	-	120	88.5	47.1	34.7	24.27	20.4	10.55
1.80V/cell	-	-	168	-	117	86.2	45.7	33.9	23.79	20.0	10.50

Constant Power Discharge (Watts/cell) at 20°C

End Point	10min	15min	30min	45min	1h	1.5h	2h	3h	5h	8h
1.60V/cell	-	-	374	268	248	182.8	137	97.4	70.3	37.34
1.65V/cell	-	-	360	262	243	179	134	96.1	69.7	37.02
1.70V/cell	-	-	347	257	238	175.2	131	94.8	69.1	36.7
1.75V/cell	-	-	332	252	233	171.4	128	93.4	68.6	36.44
1.80V/cell	-	-	319	247	228	167.2	124	92.4	68.1	36.17

Discharge Characteristics

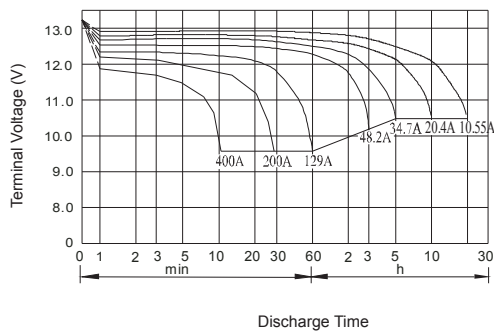

Float Charging Characteristics

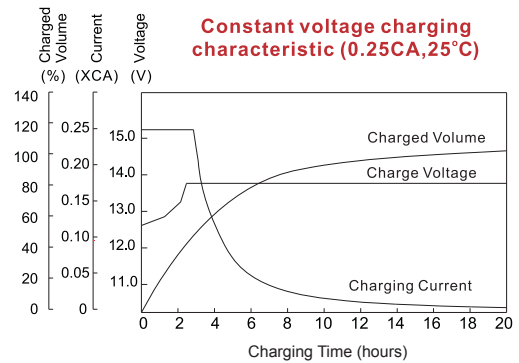

Temperature Effects in Relation to Battery Capacity

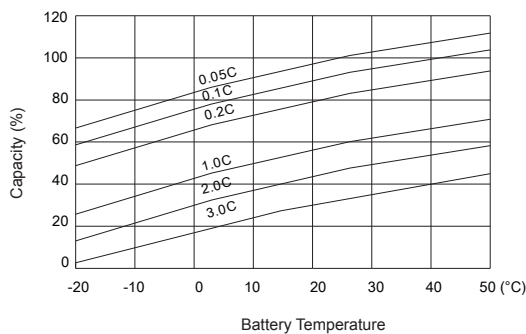

Effect of Temperature on Long Term Float Life

